

33 Ranelagh Gardens
Mansions
London
SW6 3UQ



33 Ranelagh Gardens Mansions

£2,690 Per Month

Full Description

The flat comprises of a separate kitchen, spacious and bright reception room (currently used as a bedroom), two further double bedrooms and shower room. The flat opens directly onto a south-facing communal patio area and has space for a small table and chairs.

Ranelagh Gardens Mansions is located adjacent to Putney Bridge Station (District Line), and the local bus terminal. Local shops and cafes are located on Ranelagh Gardens; a further selection of shops and restaurants are within easy walking distance on the New King's Road and Putney High Street. The River and open-space of Bishops Park are a short stroll away.

Local Authority

London Borough of Hammersmith and Fulham

Council Tax Band D

EPC Rating E



Contact

0208 994 5164

karen@xppm.co.uk

xppm.co.uk

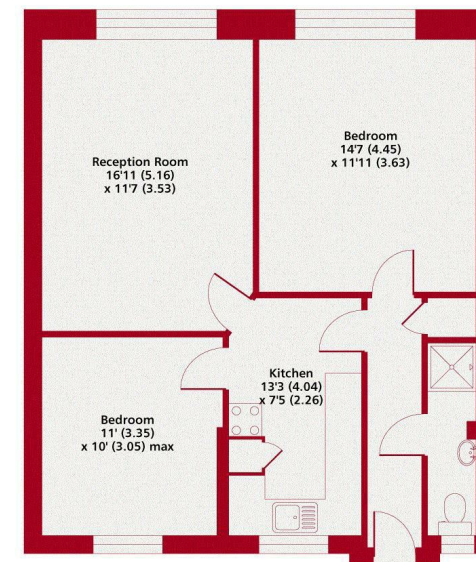

Ground Floor